

## General information

PWS1520260307

The PTA shear beam load cell, built in nickel-plated steel, has excellent precision, linearity and creep characteristics and has been designed for weighing tanks, hoppers, belts, platforms, single-cell systems, suspended loads and automatic packaging machines. The PTA cell is resistant to lateral loads exceeding 50% of the Rated Capacity and is supplied with a 4-conductor shielded cable 4 meters long (0.5 - 2 t) or 6 meters (3 - 5 t). **The PTA bidirectional load cell is suitable for tension and compression industrial applications.**



## Suggested related products

A highly performing weighing system must be accurate, perfectly calibrated and well maintained. In order to improve the load cell performance and to optimize its functioning, you may need the following products:

**Weight Transmitter** [DAT 1400](#)

**Weight Indicator** [MCT 1302](#)

**Mounting kits** [MKX ®](#)

**Tester 1008** [TESTER 1008](#)

**Junction Box** [CGS4-C](#)

**Double Shear Beam Load Cell** [DDR](#)

All indicated data may be changed without notice.  
All the measures indicated are expressed in millimeters (mm).

## Technical specifications

PWS1520260307

<b>Rated Load (RL):</b>	0.1, 0.25, 0.5, 1, 1.5, 2, 2.5, 3, 5 t
<b>Combined error:</b>	±0.023 % RO
<b>Repeatability:</b>	±0.01 % RO
<b>Creep (30 minutes):</b>	±0.02 % RO
<b>Safe overload:</b>	150 % RL
<b>Ultimate overload:</b>	300 % RL
<b>Clamping force without any load:</b>	M12= 75Nm; M18= 500Nm
<b>Material:</b>	Stainless steel
<b>Degree of protection:</b>	IP67
<b>Accuracy class:</b>	3000 OIML
<b>Deflection:</b>	0.2 ÷ 1.4 mm
<b>Compensated Temperature:</b>	-10 ÷ +40°C
<b>Temperature range:</b>	-35 ÷ +65°C
<b>Temperature effect on zero balance:</b>	±0.018 % RO/10°C
<b>Temperature effect on output:</b>	±0.014 % output/10°C
<b>Rated output RO:</b>	3.0 ± 0.003 mV/V
<b>Zero balance:</b>	±1 % RO
<b>Insulation resistance:</b>	> 5000 MOhm
<b>Input resistance:</b>	350 ±3.5 Ohm
<b>Output resistance:</b>	350 ±3.5 Ohm
<b>Recommended input:</b>	5 ÷ 12 Vdc/ca

All indicated data may be changed without notice.  
 All the measures indicated are expressed in millimeters (mm).

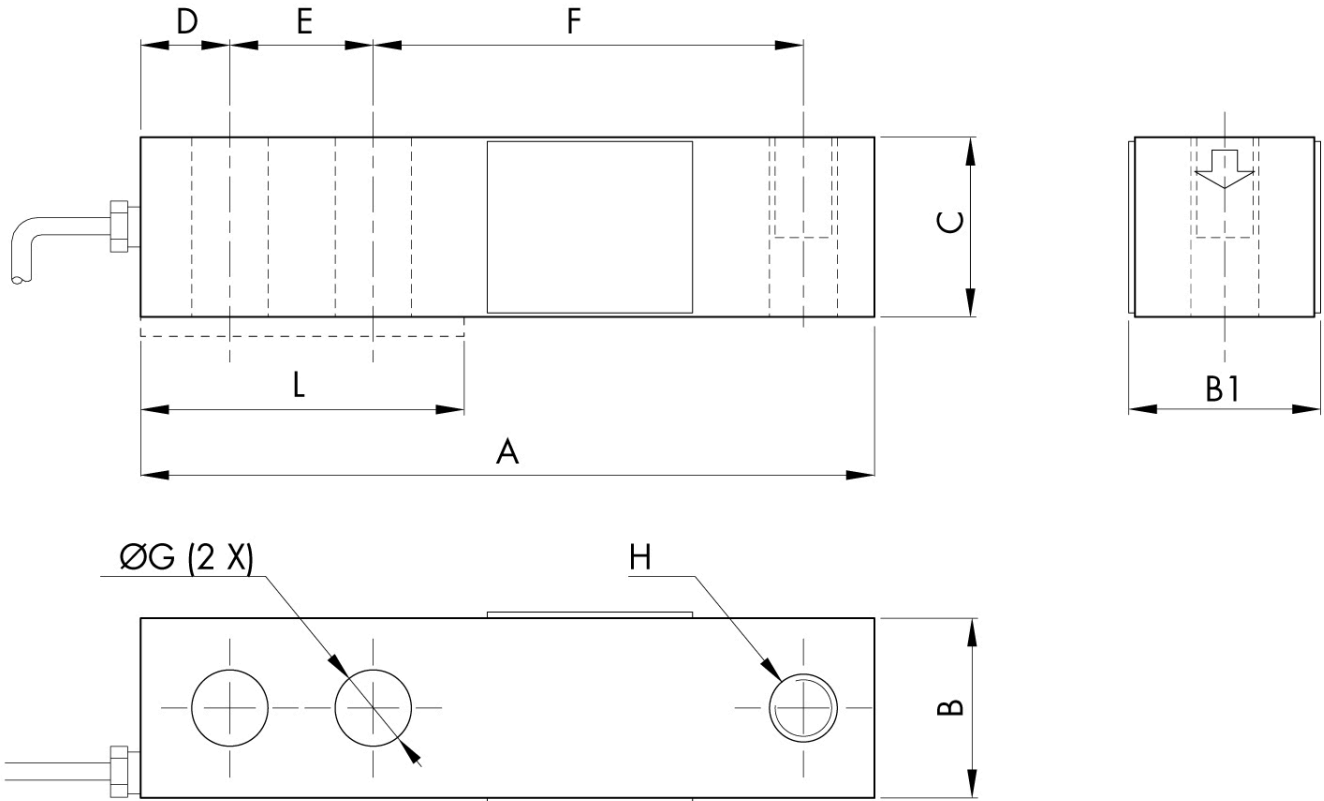

CAPACITY kg	100-2000	2500-5000
A	130	171.5
B	31.8	38.1
B1	34	40
C	31.8	38.1
D	15.8	19.1
E	25.4	38.1
F	76.2	95.3
G	13.5	20.6
H	M12x1.75	M18x1.5
L	54	77

All indicated data may be changed without notice.  
 All the measures indicated are expressed in millimeters (mm).