

Technical specifications

PWS11020250622

The CGS4-S ATEX junction box is able to connect several load cells: it synchronizes measurements and it ensures correct and accurate weight values. The CGS4-S ATEX junction box collects the signals of the individual cells and translates them into a single signal. Our junction boxes are equipped with a quick connector for the connection to our Tester 1008, which allows the immediate control of the signals of the single cells and the system diagnostics.

| | |
|-----------------------------|------------------------------|
| Temperature range: | -10 ÷ +50 °C |
| Storage temperature: | -20 ÷ +70 °C |
| Drilling template: | 108 x 45 mm (L x H) |
| Dimensions: | 125 x 79 x 40 mm (L x H x D) |

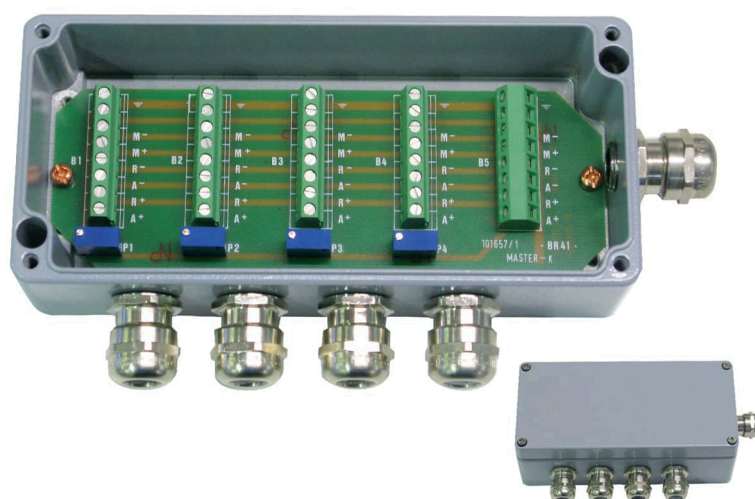

All indicated data may be changed without notice.
All the measures indicated are expressed in millimeters (mm).

Junction Box **CGS4-S ATEX**

available with certification • UL • EAC • ATEX

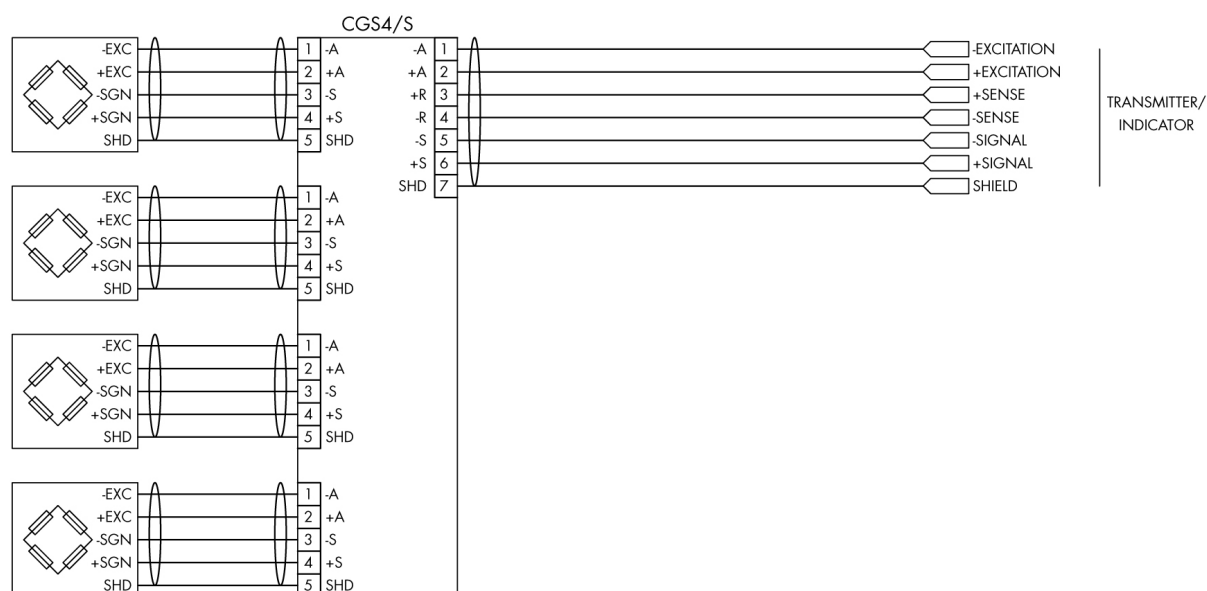

LOAD CELLS COLOUR CODE

| | | | | |
|------|---------------|-------------|---------|-------------|
| +Exc | Red | Red/Green | Red | Red/Blue |
| -Exc | Black | Black | White | Black/Brown |
| +Sgn | Green | Green/White | Green | Green |
| -Sgn | White | Red/White | Blue | White |
| Shd | Shield | Shield | Shield | Shield |
| | SENSORTRONICS | NOBEL | MINEBEA | PAVONE |

All indicated data may be changed without notice.
All the measures indicated are expressed in millimeters (mm).

Junction Box **CGS4-S ATEX**

available with certification • UL • EAC • ATEX

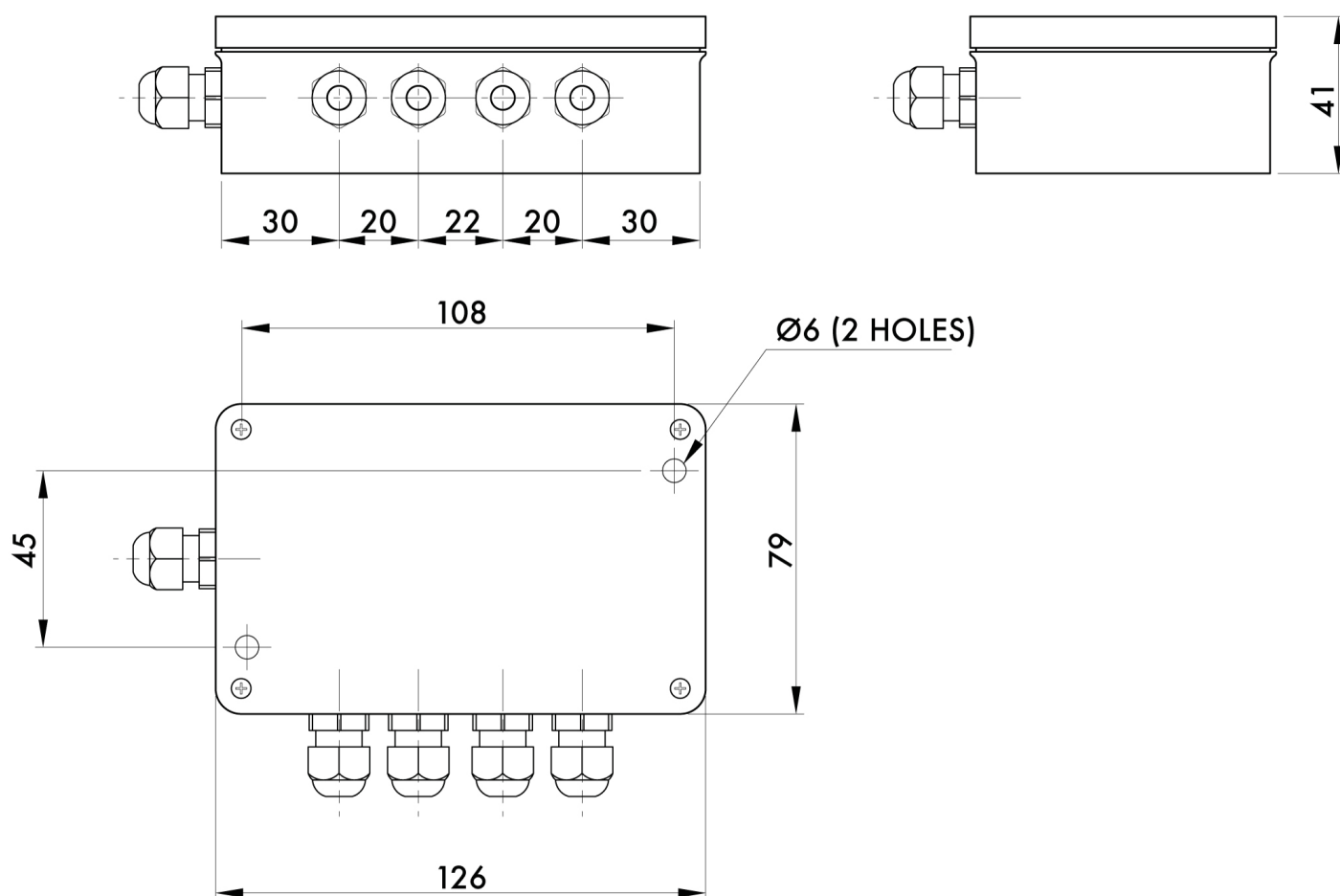

All indicated data may be changed without notice.
All the measures indicated are expressed in millimeters (mm).